

VERWARMING EN VENTILATIE

Aurora
w



Reken op ons.

Auerhaan Lelystad is een bedrijf met een zeer lange historie; opgericht in 1885, is het bedrijf een bekende en betrouwbare toeleverancier van producten voor de carrosseriebouw, busbouw, machinebouw, scheepsbouw en jachtbouw. Vele vertegenwoordigingen van gerenommeerde fabrikanten in Europa en daarbuiten maken het productassortiment van Auerhaan tot een zeer breed programma. Het mag u dan ook duidelijk zijn dat de informatie die wij u geven via deze website nooit compleet kan zijn.



WATER VALVES

MASTERS OF LIQUID FLOW

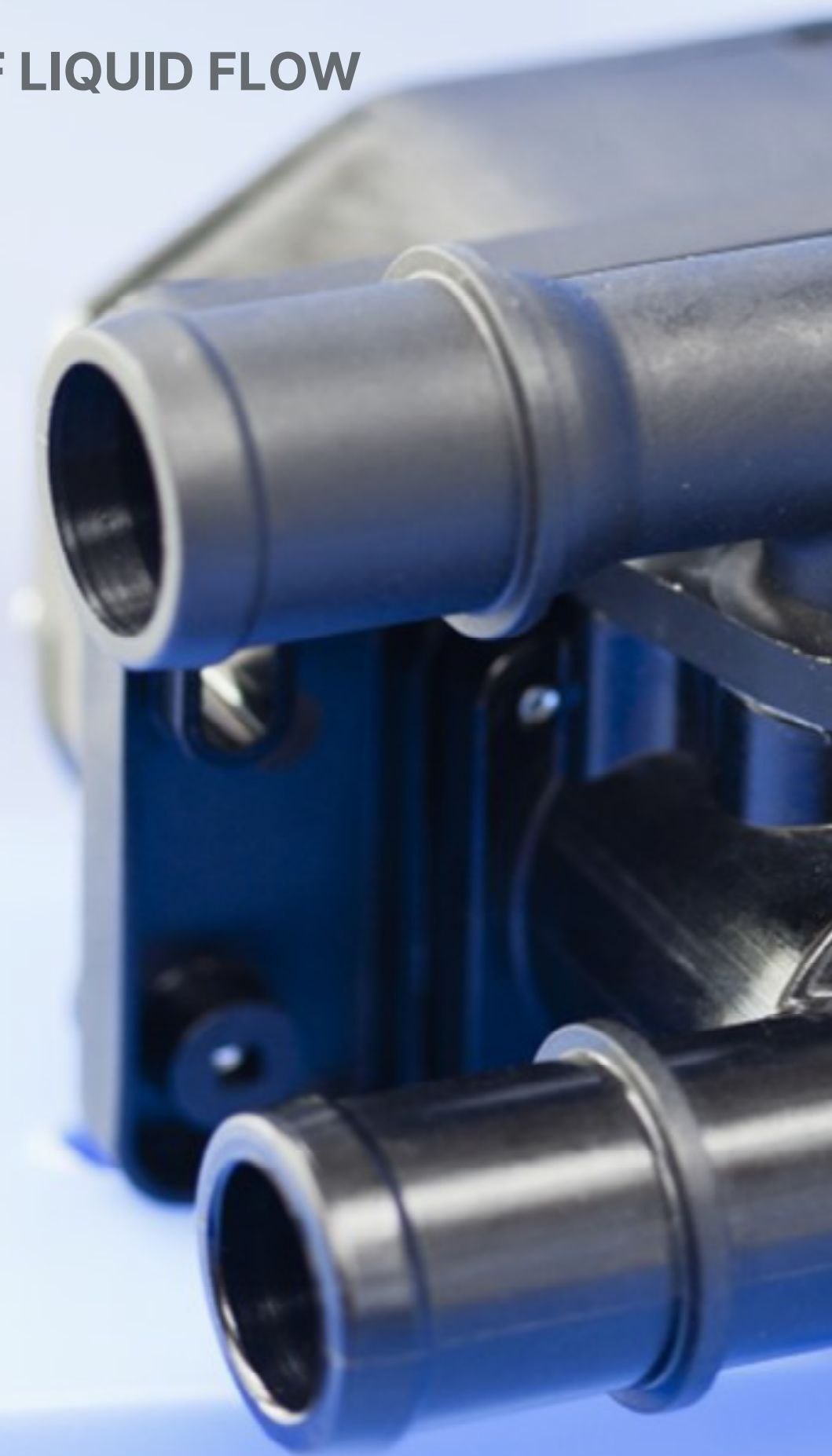

AURORA

/ Pioneering Your Comfort



WATER VALVES

MECHANICAL BOWDEN CABLE

Mechanical Water Valves control the heating performance via easy adjustable Bowden Cables. Standard connection diameters are Ø 16 mm / 18 mm / 22 mm / 28 mm. Varied connecting diameters are also available upon request. This water valve has mostly linear operating characteristics, and operates efficiently with a minimum pressure loss.

The valve housing is comprised of Polyamide 66 Material, providing AURORA's line of water valves with lightweight and non-corrodible qualities.

Specifications	
Flow medium: water with antifreeze (mixture ratio max. 1:1) Volumetric flow: 100-1.200 l/h Operating temperature range: -40°C to +100°C fluid temp. Environmental temperature range: -40°C to +85°C Nominal pressure of liquid: p = 1 bar relative Test pressure of the water valve: p1 = 2.5 bar absolute	
Technical Information	
912-100-0007	
Variations	
Part Number	Description
381-000-0141	Ø 16/16 with lever Bowden Wire Pos. A
381-000-0142	Ø 16/16 with lever Bowden Wire Pos. B
381-000-0143	Ø 16/16 with lever Bowden Wire Pos. C
381-000-0144	Ø 16/16 with lever Bowden Wire Pos. D
381-000-0145	Ø 22/22 with lever Bowden Wire Pos. A
381-000-0146	Ø 22/22 with lever Bowden Wire Pos. B
381-000-0147	Ø 22/22 with lever Bowden Wire Pos. C
381-000-0148	Ø 22/22 with lever Bowden Wire Pos. D
381-000-0149	Ø 28/28 with lever Bowden Wire Pos. A
381-000-0150	Ø 28/28 with lever Bowden Wire Pos. B
381-000-0151	Ø 28/28 with lever Bowden Wire Pos. C
381-000-0152	Ø 28/28 with lever Bowden Wire Pos. D
381-000-0170	Ø 18/18 with lever Bowden Wire Pos. A
381-000-0171	Ø 18/18 with lever Bowden Wire Pos. B
381-000-0158	Ø 18/18 with lever Bowden Wire Pos. C
381-000-0172	Ø 18/18 with lever Bowden Wire Pos. D



WATER VALVES

MECHANICAL BOWDEN CABLE

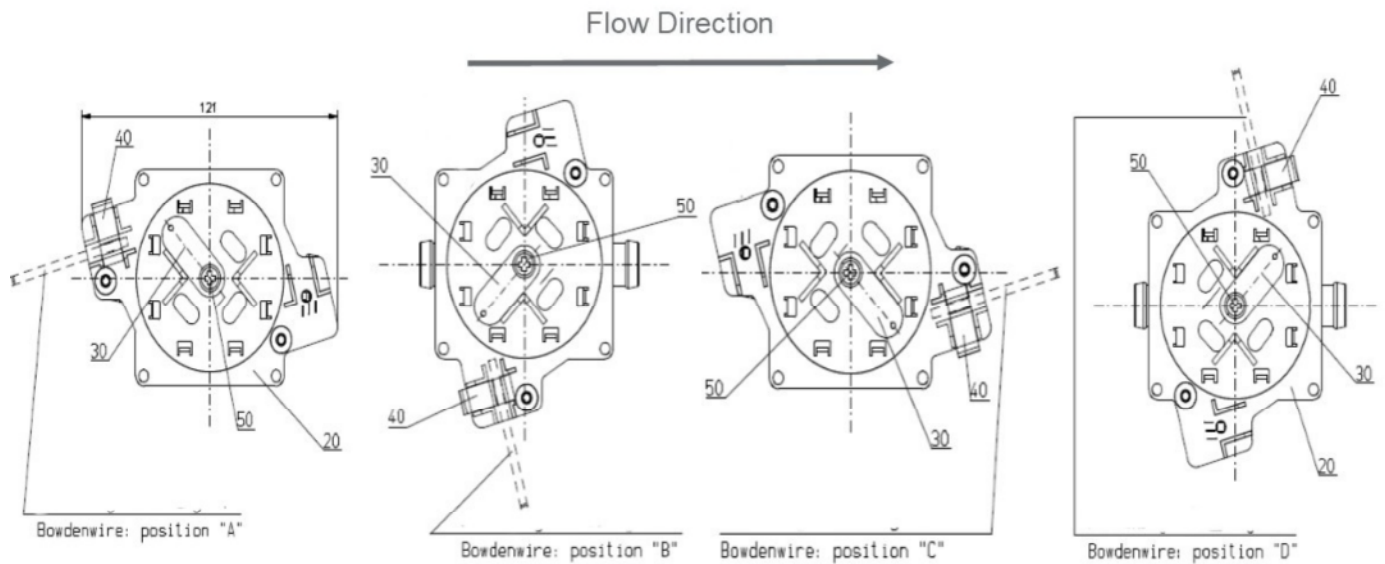

WATER VALVES

5 POLE WITH SERVO MOTOR

Electrical Water Valve with Servo Motor 5 Pole with varied diameters. Standard connection diameters are 16 mm / 18 mm / 22 mm / 28 mm. Control of this valve is steered by a 5-pole Servo Motor, providing easy adjustment of the heating performance. Varied connecting diameters are also available upon request. Servo Motors available in both 12 and 24 Volts. This water valve has mostly linear operating characteristics, and operates efficiently with minimum pressure loss. The valve housing is comprised of Polyamide 66 Material, giving AURORA's line of water valves with lightweight and non-corrodible qualities.

Specifications		
Flow medium: water with antifreeze with mix ratio max. 1:1 Volumetric flow: 100-1.200 l/h Operating temperature range: -40°C to +100°C fluid temperature Environmental temperature range: -40°C to +85°C Nominal pressure of the fluid: p = 1 bar relative Test pressure of the water valve p1 = 2.5 bar absolute		
Technical Information		
912-100-0007/421		
Variations		
Part Number	Diameter Ø	Voltage (V)
381-000-0312	16/16	24 V
381-000-0350	16/16	12 V
381-000-0318	22/22	24 V
381-000-0352	22/22	12 V
381-000-0319	28/28	24 V
381-000-0354	28/28	12 V
381-000-0390	18/18	12 V
381-000-0339	18/18	24 V



WATER VALVES

5 POLE WITH SERVO MOTOR

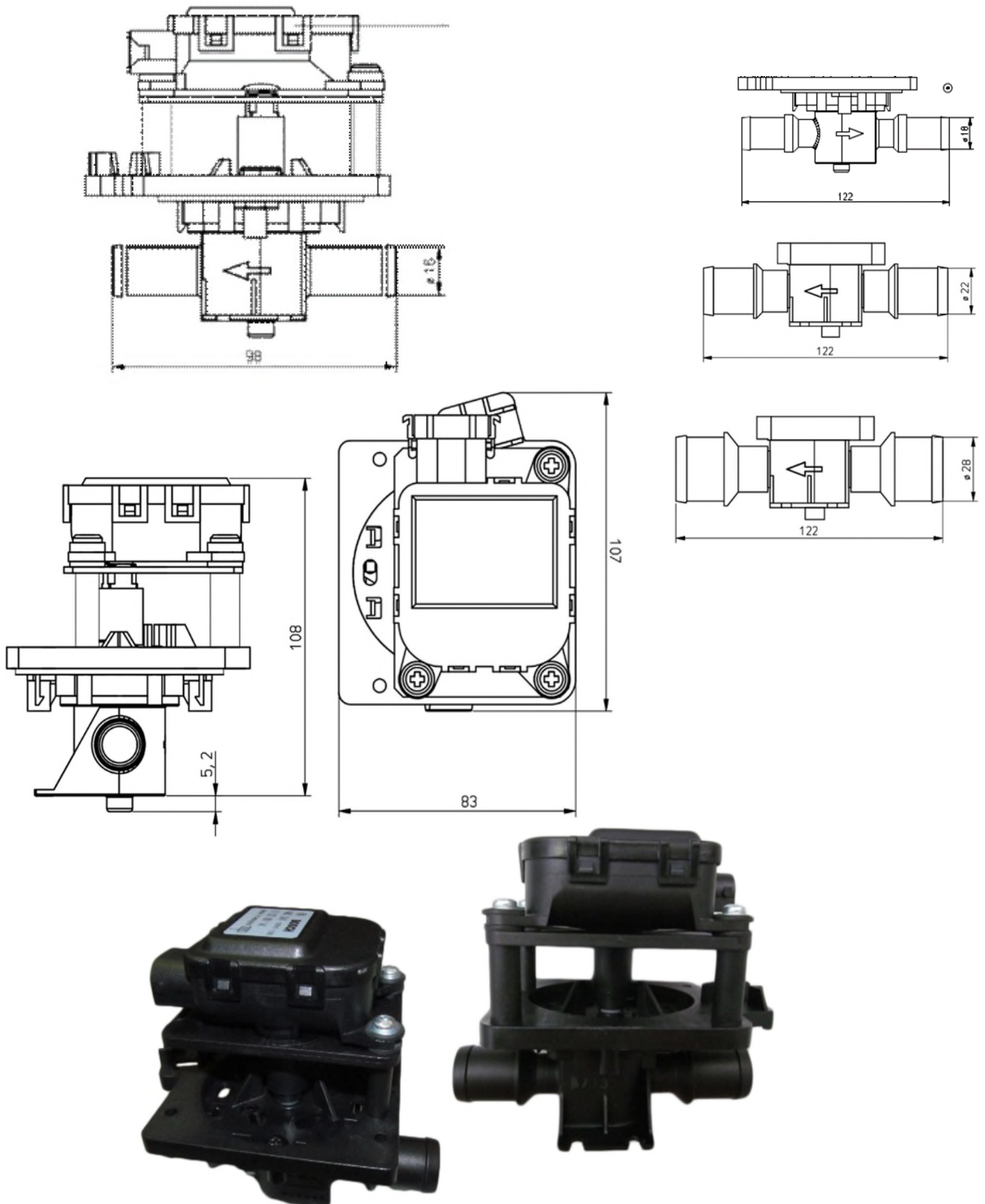

WATER VALVES

2-WAYS WITH 3 POLES SERVO MOTOR

Electrical Water Valve with Servo Motor 3 Pole with varied diameters. Control of this valve is direct by a control voltage to the Servo Motor, providing easy adjustment of the heating performance. Varied connecting diameters are also available upon request. This water valve has mostly linear operating characteristics, and operates efficiently with minimum pressure loss. The valve housing is comprised of Polyamide 66 Material.

Specifications		
Flow medium: water with antifreeze with mix ratio max. 1:1		
Volumetric flow: 100-1.200 l/h		
Operating temperature range: -40°C to +100°C fluid temperature		
Environmental temperature range: -40°C to +85°C		
Nominal pressure of the fluid: p = 1 bar relative		
Test pressure of the water valve p1 = 2.5 bar absolute		
Technical Information		
912-100-0007/0957		
Variations		
Part Number	Diameter Ø	Voltage (V)
381-000-0401	16/16	24 V
381-000-0402	22/22	24 V
381-000-0451	16/16	12 V

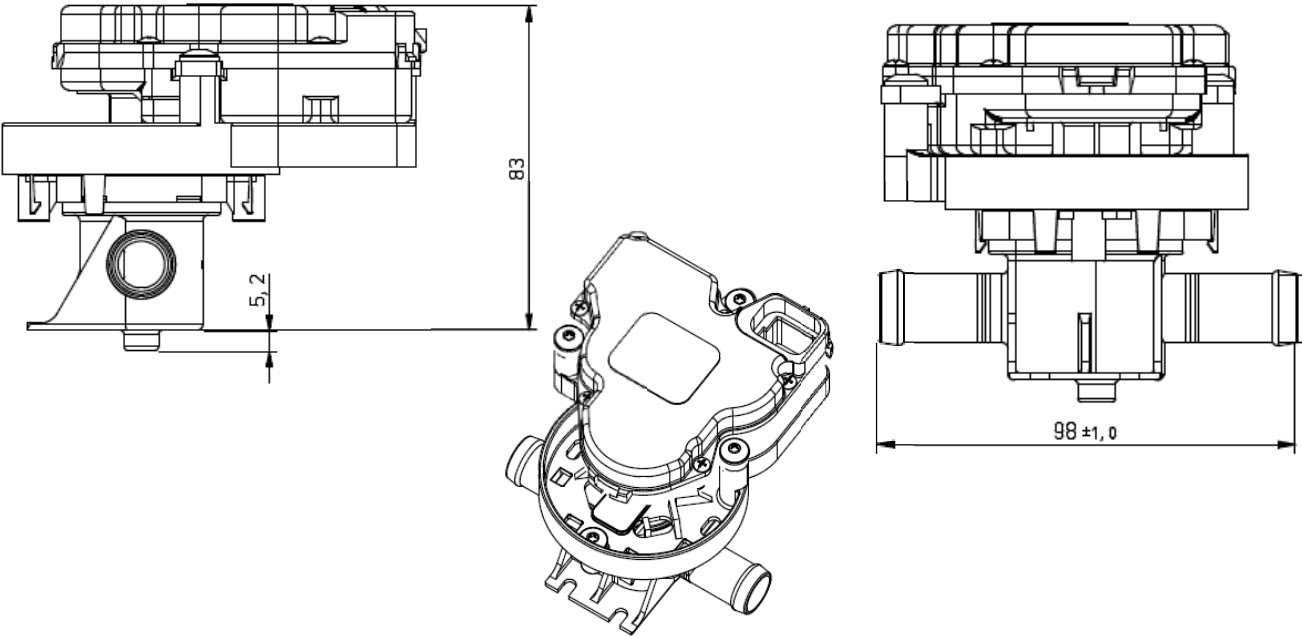

WATER VALVES

SERVO MOTOR LINBUS

Electrical Water Valve with Servo Motor LINBUS controlled. Control of this valve is by LINBUS signal, providing easy adjustment of the heating performance. Varied connecting diameters are also available upon request. This water valve has mostly linear operating characteristics, and operates efficiently with minimum pressure loss. The valve housing is comprised of Polyamide 66 Material.

Specifications		
Flow medium: water with antifreeze with mix ratio max. 1:1 Volumetric flow: 100-1.200 l/h Operating temperature range: -40°C to +100°C fluid temperature Environmental temperature range: -40°C to +85°C Nominal pressure of the fluid: p = 1 bar relative Test pressure of the water valve p1 = 2.5 bar absolute		
Technical Information		
912-100-0007/0978		
Variations		
Part Number	Diameter Ø	Voltage (V)
381-000-0042	18/18	12 V

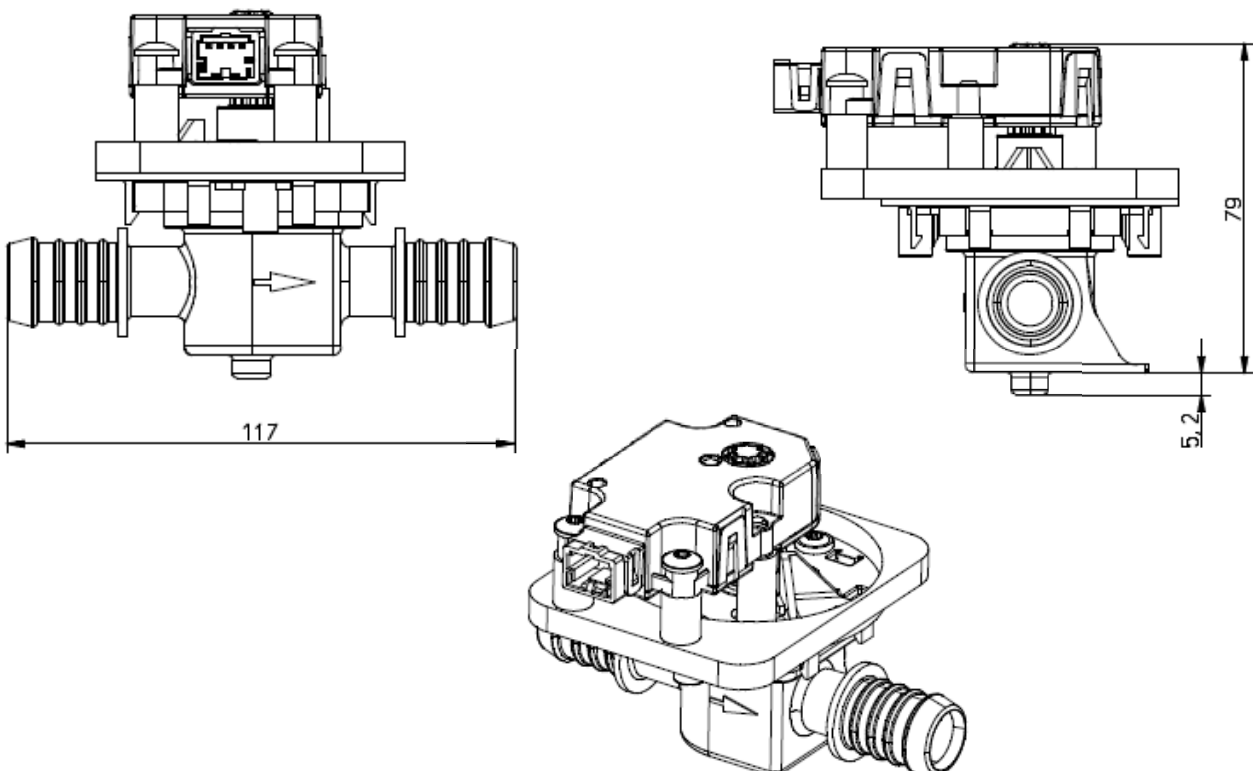

AURORA[®]

/ Pioneering Your Comfort





CONTROL PANELS

**INTELLIGENT-RESPONSIVENESS,
DYNAMIC; USER-FRIENDLY**

CONTROL PANELS

NEO2B

AURORA's NEO2B Control Panel is designed for the rough and tough operator. For this, we've stripped out all the extra bells and whistles to give customers exactly what they need: simplicity and functionality. The NEO2B has two knobs and up to two rocker switches, all electronically manipulated. It is designed for a 3-speed blower and optional rocker switches for AC and recirculation.

Functions	Specification
3-Step rotary switch for blower speed (25A)	Operation voltage 9 to 30 V
Potentiometer for water valve position	Operation temperature -40°C to +85°C
5-Pol. actuator for water valve	IP40 (front side)
Push button for AC (optional)	15 pol. AMP connector
Rocker switch for recirculation flap (optional)	
Illuminated symbols	
Illuminated knobs	
Function and status LED's	

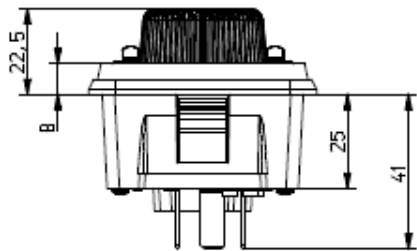
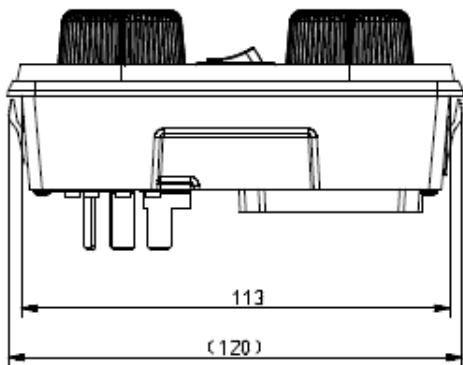

CONTROL PANELS

NEO3B

AURORA’s NEO3B Control Panel is designed for the rough and tough operator. For this line, we’ve stripped out all the extra bells and whistles to give customers exactly what they need: simplicity and functionality. The NEO3B has three knobs and up to two rocker switches, all electronically manipulated. It is designed for a 3-speed blower, proportionally positioned air distribution flap and optional rocker switches for AC and recirculation.

Functions	Specification
3-Step rotary switch for blower speed (25A)	Operation voltage 9 to 30 V
Potentiometer for watervalue position	Operation temperature -40°C to +85°C
3-Pol. actuator for watervalue	IP40 (front side)
Potentiometer for air distribution flap position	1 x 15 pol. AMP connector
3-Pol. actuator for air distribution flap	
Rocker switch for AC (optional)	
Rocker switch for recirculation flap (optional)	
Illuminated symbols	
Illuminated knobs	

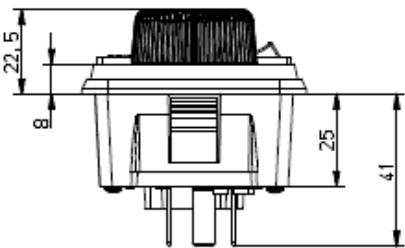
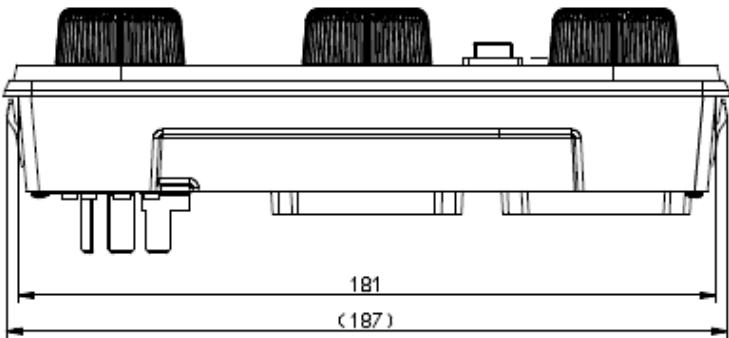

CONTROL PANELS

NEO2

AURORA’s NEO2 Control Panel is designed for the rough and tough operator. For this line, we’ve stripped out all the extra bells and whistles to give customers exactly what they need: simplicity and functionality. The NEO2 has two knobs and up to two rocker switches, all electronically manipulated. It is designed for a 3-speed blower and optional rocker switches for AC and recirculation .

Functions	Specification
3-Step rotary switch for blower speed (25A)	Operation voltage 9 to 30 V
Potentiometer for water valve position	Operation temperature -40°C to +85°C
5-Pol. actuator for water valve	IP54 (front side)
Push button for AC (optional)	1 × 15 pol. AMP connector
Rocker switch for recirculation flap (optional)	
Illuminated symbols	
Illuminated knobs	
Function and status LED's	

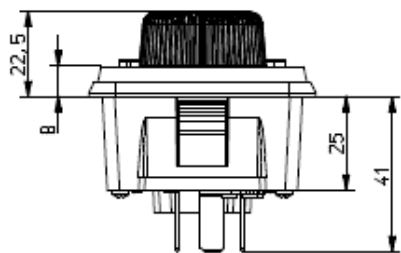
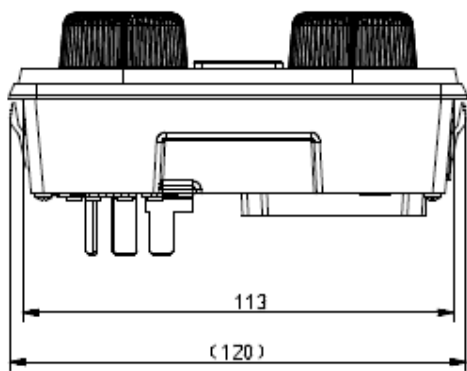

CONTROL PANELS

NEO3

AURORA’s NEO3 Control Panel is designed for the rough and tough operator. For this line, we’ve stripped out all the extra bells and whistles to give customers exactly what they need: simplicity and functionality. The NEO3 has three knobs and up to two rocker switches, all electronically manipulated. It is designed for a 3-speed blower, proportionally positioned air distribution flap and optional rocker switches for AC and recirculation.

Functions	Specification
3-Step rotary switch for blower speed (25A)	Operation voltage 9 to 30 V
Potentiometer for watervalue position	Operation temperature -40°C to +85°C
5-Pol. actuator for watervalue	IP54 (front side)
Potentiometer for air distribution flap position	2 × 15 pol. AMP connector
5-Pol. actuator for air distribution flap	
Push button for AC (optional)	
Push button for recirculation flap (optional)	
Illuminated symbols	
Illuminated knobs	
Function and status LED’s	

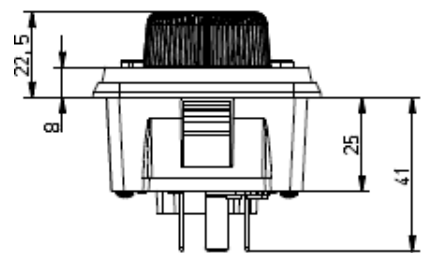
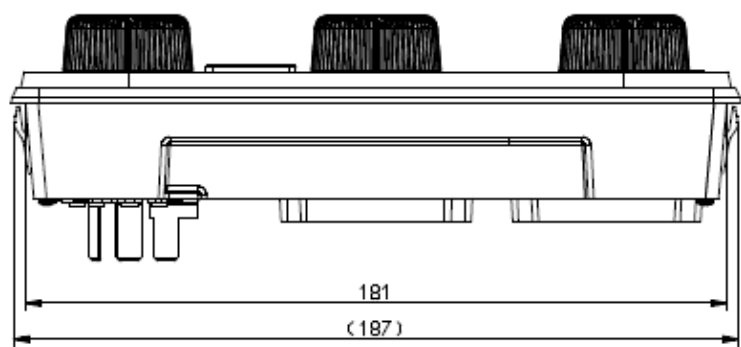

CONTROL PANELS

NEO2PLUS

AURORA's NEO2PLUS takes the next step towards ultimate climate control in a cabin or vehicle. The NEO2plus has an encoder that is used for multiple functions, two push-buttons and a round OLED display with a resolution of 128×128px. It is designed to connect a stepless blower; it has a CAN-bus interface, and up to three sensors can be connected.

Functions	Specification
Encoder for set temperature and blower speed	Operation voltage 9 to 30 V
PWM output for stepless blower	Operation temperature -40°C to +85°C
Upper push button for defrost function	IP54 (front side)
Lower push button for menu and AC	1 × 15 pol. AMP connector
Background illumination	
CAN bus interface	
3 temperature sensors	
OLED display	
Function and status LED's	
Configuration menu	

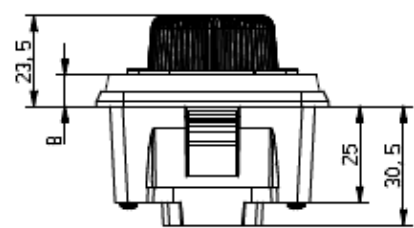
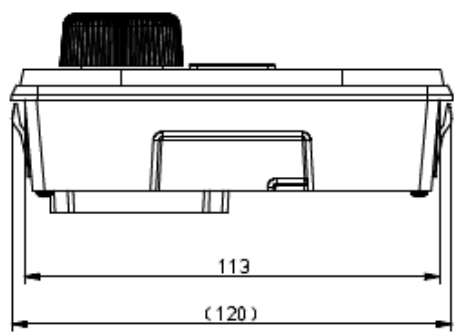

CONTROL PANELS

NEO3PLUS

AURORA's NEO3PLUS takes the next step towards ultimate climate control in a cabin or vehicle. The NEO3plus has an encoder that is used for multiple functions, a potentiometer for the air distribution, two pus-buttons and a round OLED display with a resolution of 128×128px. It is designed to connect a stepless blower, it has a CAN-bus interface and up to four sensors can be connected.

Functions	Specification
Encoder for set temperature and blower speed	Operation voltage 9 to 30 V
PWM output for stepless blower	Operation temperature -40°C to +85°C
Potentiometer for air distribution	IP54 (front side)
Upper push button for defrost function	2 × 15 pol. AMP connector
Lower push button for menu and AC	
Background illumination	
CAN bus interface	
Up to 4 temperature sensors	
Up to 2 air flap actuators	
Recirculation flap	
OLED display	
Function and status LED's	
Configuration menu	

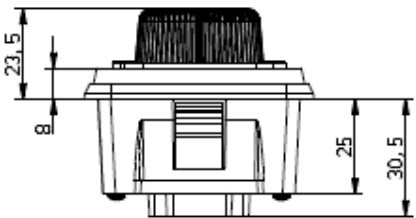
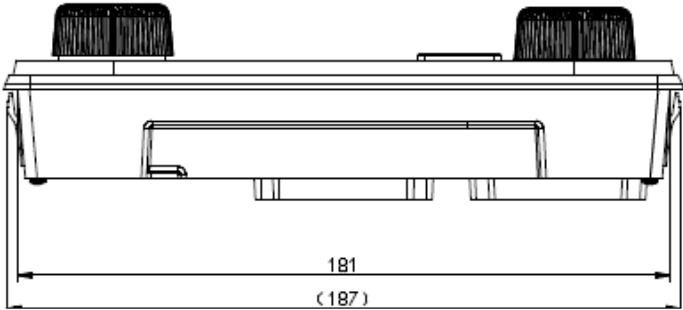

Poseidonweg 39
8239 DK Lelystad

T 0320 - 28 61 71
E lelystad@auerhaan.nl
W auerhaan-lelystad.nl

Reken op ons.

